



Price List

ALUMINUM SLIDING DOORS

LAZURYT

[For specs click HERE](#)

**Partitions Closets
Corner Configs
Wall Units**



KOMANDOR

Prices valid until Dec 31, 2025

INTRODUCTION – Using this Guide

Systems have been priced out using:

- the most common measurements to estimate costs
- includes doors and top & bottom track
- no decorative trims (mullions or joiner rails)

- Frame Finish **BASE** colours
- Insert **BASE** colours
- Please apply % increase to the original base price for other options as listed

- widths and heights indicate finished openings
- width: minimums and maximums
- height: maximums



All sliding doors are measured, designed & fabricated to the 1/32"

Industry Professionals Trade Pricing

The Industry Professional placing the order may take their Trade Pricing discount off the full MSRP of product listed in this Price Guide (delivery and install excluded).

Prices are listed at full MSRP in the guide and do not include taxes.

Charges for freight, crating (if applicable) and brokerage for out of area orders apply, please inquire for a quote.

LAZURYT
system

Frame Finish Options



BASE
as priced

Natural (clear)
anode
Black

+10% on base Champagne
anodized

+20% on base Graphite anodized
Gold Shiny

By Inquiry White

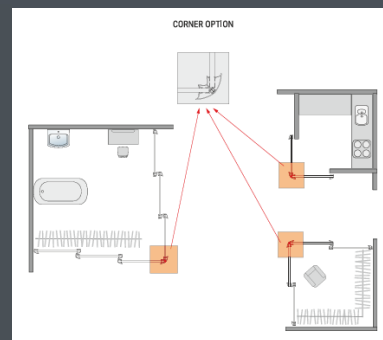
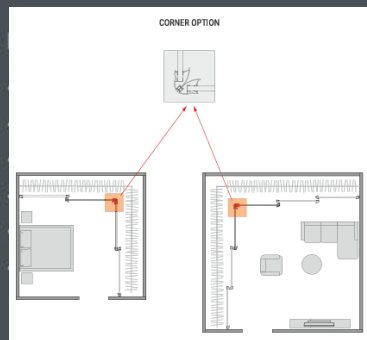

PROFILE COLORS

white

black

gold

anode
champagne

anode
graphite

anode
natural



Special
Order



LAZURYT - Bi-Pass aluminum sliding doors & Partitions

PANEL INSERT



Panel Options

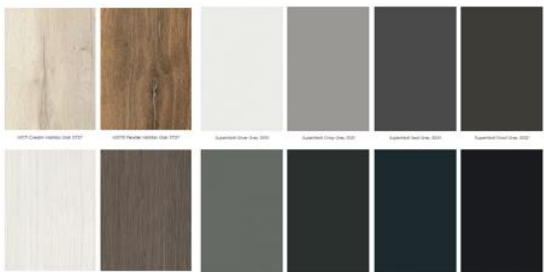

BASE
as priced

Black Grain
Black VL
Grey
White (Aspen)
White Polar

Opening Width	Number of Doors	Price up to 84" Height	Price up to 110" Height
36"	2	\$1,475	\$1,550
36-48"	2	\$1,600	\$1,675
48-60"	2	\$1,750	\$1,825
60-72"	2	\$1,825	\$1,925
72-84"	2	\$2,000	\$2,100
84-96"	2	\$2,075	\$2,200
84-96"	3	\$2,675	\$2,800
96-108"	3	\$2,750	\$2,900
108-120"	3	\$2,950	\$3,100
120-132"	3	\$3,025	\$3,200
132-144"	3	\$3,100	\$3,300
132-144"	4	\$3,675	\$3,875
144-156"	4	\$3,900	\$4,100
156-168"	4	\$3,975	\$4,200
168-180"	4	\$4,050	\$4,300
180-196"	5	\$4,875	\$5,150

+5% on base

Alderwood
Ancient Oak
Beech
Vanilla
Walnut

+8% on base

Antique Oak
Bergamo Elm
Chocolate Pine
Cortona Oak
Dark Walnut

Lucerne Elm
Mali Weng
Metallic
Natural Maple
Nicea Walnut

Palermo Dark Oak
Palermo Light Oak
Pine
Rijeka Oak
Sonoma Oak

White Alaskan
Whitewashed Pine
White Porcelain

Hardware Upgrades

- * Soft close mechanisms
- * Horizontal woodgrain
- * Horizontal mullion dividers
- * Combine different inserts
- * Single, double, triple tracks

LAZURYT - Bi-Pass aluminum sliding doors & Partitions

MIRROR INSERT



Mirror Options



UC 002/3/4/6-T
2mm, 3mm, 4mm, 6mm



UC 300/600B-T
3mm, 6mm



UC 600GRY-T
6mm

BASE
as priced

Silver (clear)

+8% on base

Bronze (brown tinted)

+30% on base

Graphite (gray tinted)

Opening Width	Number of Doors	Price up to 84" Height	Price up to 110" Height
36"	2	\$1,650	\$1,750
36-48"	2	\$1,825	\$1,950
48-60"	2	\$2,025	\$2,200
60-72"	2	\$2,150	\$2,375
72-84"	2	\$2,375	\$2,600
84-96"	2	\$2,500	\$2,775
84-96"	3	\$3,100	\$3,375
96-108"	3	\$3,250	\$3,550
108-120"	3	\$3,475	\$3,825
120-132"	3	\$3,625	\$4,000
132-144"	3	\$3,750	\$4,150
132-144"	4	\$4,325	\$4,725
144-156"	4	\$4,600	\$5,050
156-168"	4	\$4,750	\$5,200
168-180"	4	\$4,875	\$5,375
180-196"	5	\$5,775	\$6,325

Hardware Upgrades

- * Soft close mechanisms
- * Horizontal mullion dividers
- * Combine different inserts
- * Single, double, triple tracks

LAZURYT - Bi-Pass aluminum sliding doors & Partitions



Antique Mirror Options



KAPA CLEAR

UG KAPA CLEAR
4mm



ZUMRE CLEAR

UG ZUMRE CLEAR
4mm



KAPA BRONZE

UG KAPA BRONZE
4mm



NIDA CLEAR

UG ZUMRE CLEAR
4mm



NIDA BRONZE

UG NIDA BRONZE
4mm



LAV CLEAR

UG LAVA CLEAR
4mm

BASE
as priced

Nida Clear
Nida Bronze
Kapa Clear
Kapa Bronze
Zumre Clear
Lava Clear

ANTIQUE MIRROR INSERT

Opening Width	Number of Doors	Price up to 84" Height	Price up to 110" Height
36"	2	\$2,325	\$2,700
36-48"	2	\$2,725	\$3,225
48-60"	2	\$3,175	\$3,825
60-72"	2	\$3,550	\$4,300
72-84"	2	\$4,000	\$4,900
84-96"	2	\$4,350	\$5,375
84-96"	3	\$4,975	\$6,000
96-108"	3	\$5,325	\$6,475
108-120"	3	\$5,825	\$7,125
120-132"	3	\$6,200	\$7,600
132-144"	3	\$6,575	\$8,100
132-144"	4	\$7,125	\$8,650
144-156"	4	\$7,625	\$9,325
156-168"	4	\$8,025	\$9,850
168-180"	4	\$8,375	\$10,325
180-196"	5	\$9,600	\$11,725

Hardware Upgrades

- * Soft close mechanisms
- * Horizontal mullion dividers
- * Combine different inserts
- * Single, double, triple tracks

Pricing for 110" high openings includes one joiner rail since antique mirror sheets are only 98" long

LAZURYT - Bi-Pass aluminum sliding doors & Partitions



Backpainted Glass Options



UG BP004BLK-T
4mm



UG BP004EXW
4mm

BASE
as priced

- Backpainted
- various colours including white, black, and a dozen other colours
 - ultra-clear

+5% on base

Starlight Black

+20% on base

Matalac (matte finish)

BACKPAINTED GLASS INSERT

Opening Width	Number of Doors	Price up to 84" Height	Price up to 110" Height
36"	2	\$1,875	\$2,125
36-48"	2	\$2,125	\$2,450
48-60"	2	\$2,425	\$2,825
60-72"	2	\$2,650	\$3,100
72-84"	2	\$2,925	\$3,500
84-96"	2	\$3,150	\$3,775
84-96"	3	\$3,750	\$4,400
96-108"	3	\$3,975	\$4,675
108-120"	3	\$4,300	\$5,100
120-132"	3	\$4,500	\$5,375
132-144"	3	\$4,725	\$5,650
132-144"	4	\$5,300	\$6,225
144-156"	4	\$5,650	\$6,725
156-168"	4	\$5,875	\$7,000
168-180"	4	\$6,100	\$7,275
180-196"	5	\$7,100	\$8,425

Hardware Upgrades

- * Soft close mechanisms
- * Horizontal mullion dividers
- * Combine different inserts
- * Single, double, triple tracks

Pricing for 110" high openings includes one joiner rail since painted glass sheets are only 100" long

LAZURYT - Bi-Pass aluminum sliding doors & Partitions

TRANSPARENT GLASS INSERT



Transparent Glass Options

BASE
as priced

Clear
laminated

Opening Width	Number of Doors	Price up to 84" Height	Price up to 110" Height
36"	2	\$2,050	\$2,300
36-48"	2	\$2,375	\$2,700
48-60"	2	\$2,725	\$3,125
60-72"	2	\$3,025	\$3,500
72-84"	2	\$3,375	\$3,925
84-96"	2	\$3,650	\$4,300
84-96"	3	\$4,250	\$4,900
96-108"	3	\$4,525	\$5,250
108-120"	3	\$4,925	\$5,725
120-132"	3	\$5,200	\$6,100
132-144"	3	\$5,500	\$6,450
132-144"	4	\$6,050	\$7,000
144-156"	4	\$6,475	\$7,525
156-168"	4	\$6,775	\$7,900
168-180"	4	\$7,050	\$8,250
180-196"	5	\$8,125	\$9,450

+3% on base

Clear tempered

+5% on base

Frosted laminated
Acid etched
Bronze tinted
Gray tinted

+4% on base

Pattern glass
(will vary from 2% up to 7% at heights +100")



Hardware Upgrades

- * Soft close mechanisms
- * Horizontal mullion dividers
- * Combine different inserts
- * Single, double, triple tracks

Pattern glass:
Pricing for 110" high openings includes one joiner rail since sheets are only 100" long

Prices in this Guide are for estimation purposes, for firm pricing connect with us for a quote.



KOMANDOR CANADA CLOSETS & DOORS INC.
863 Rangeview Rd., Mississauga, ON L5E 1H1
tel: 905.766.0880 www.komandor.ca