



BUDGET ALUMINUM SLIDING DOORS

WINNIPEG

**Closets
Wall Units**



WINNIPEG

system



Winnipeg – available in 3 different profiles, this product line is a lighter and slimmed down version of our Agat Lazuryt, and Onyx lines. Winnipeg combines the functionality of the frame serving as a handle, with its three classic shapes.

The Winnipeg system allows for the production of sliding doors and the combination of various insert materials within one door. It is also possible to use decorative strips in the colour of the system.

Roller hardware is visible in the four corners of the door on the back side; this line lends itself to opaque inserts such as panel, mirror and back painted glass.

PARAMETERS

- max door height 2.70 m
- max door width: 1.25 m

PROPERTIES

- anti-jumping function protects the door against falling out of the bottom track
- buffer strips with short and long hair reduce vibrations when closing the door and protect the interior against dust
- rollers equipped with bearings ensure light door sliding with ease
- quiet work of the running gear
- possibility of using the door closers ensuring soft closing of the door



PROFILE COLORS

anode natural



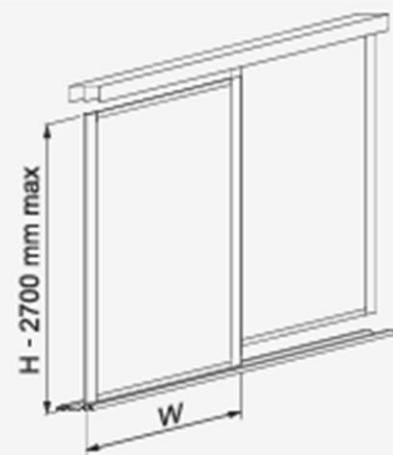

W = 450+1250 mm - panel 10 mm
 W = 450+1250 mm - glass 4 mm

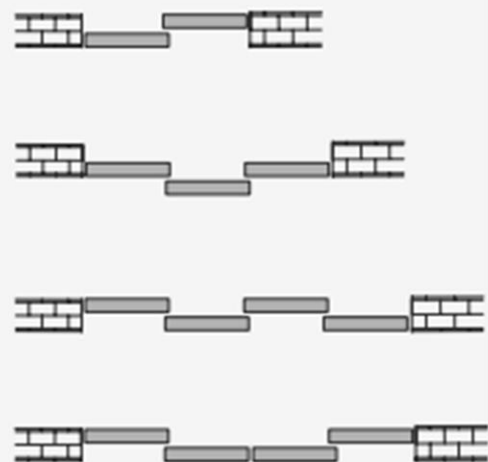

Insert materials - Glazing

Clear & Coloured Mirrors



CLEAR MIRROR

UG 002/3/4/6-T
2mm, 3mm, 4mm, 6mm



BRONZE MIRROR

UG 300/600B-T
3mm, 6mm



GREY MIRROR

UG 600GRY-T
6mm

Acid Etched Glass



ACID ETCHED

UG 203-T, UG 378-T, UG 206-T
3mm, 4mm, 6mm

Back Painted Glass



BLACK BACK PAINTED

UG BP004BLK-T
4mm



WHITE BACK PAINTED
(EXTRA CLEAR)

UG BP004EXW
4mm

Over 20 styles

- regular or matte finish
- various colours
- ultra-clear and metallic

Antique Mirrors



KAPA CLEAR

UG KAPA CLEAR
4mm



ZUMRE CLEAR

UG ZUMRE CLEAR
4mm



KAPA BRONZE

UG KAPA BRONZE
4mm



NIDA CLEAR

UG ZUMRE CLEAR
4mm

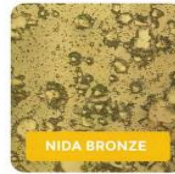

NIDA BRONZE

UG NIDA BRONZE
4mm



LAV CLEAR

UG LAVA CLEAR
4mm

Insert materials - Panel

European low VOC imports – below is a small sampling of finishes offered



H1776 White Wash Oak ST37 H1892 Natural Wash Oak ST37 H1171 Cream Wash Oak ST37 H2776 Pewter Wash Oak ST37



H1887 Tobacco Wash Oak ST37 H2182 Black Wash Oak ST37 H3125 White FineLine ST19 H2182 Dark Gray FineLine ST19



F422 White Linen ST12 F418 Beige Textile ST12 F417 Gray Textile ST12 F422 Anthracite Linen ST12



F500 Metallic Iron ST20 F754 Burned Brass ST20 U281 Graphite Gray ST9 U201 Pebble Gray ST9



SuperMatt Silver Gray 3018 SuperMatt Crisp Gray 3021 SuperMatt Seal Gray 3024 SuperMatt Frost Gray 3022



SuperMatt Mint Green 3018 SuperMatt Hunter Green 3027 SuperMatt High Seas 3029 SuperMatt Royal Blue 3031



SuperMatt Rose Pink 3018 SuperMatt Merlot Red 3028 SuperMatt Java Brown 3025 SuperMatt Onyx Black 3010



White HG 801 Galaxy White HG 870 Antique White HG 847 Matrix HG 875



Arctic Gray HG 301 ECO Light Gray HG 808 Sunset Gray HG 802 ECO Vision HG 8017



Slate Gray HG 425 Metallic Anthracite 808 HG Red HG 800 Black HG 8002



Milano Walnut HG 827 Imperia HG 822 Ebony HG 804 Swallow Eye HG 803

Textured
High Gloss
SuperMatt
Specialty
Soft Touch



DRZWI PRZESUWNE SERIA 23 SLIDING DOORS THE 23 SERIES

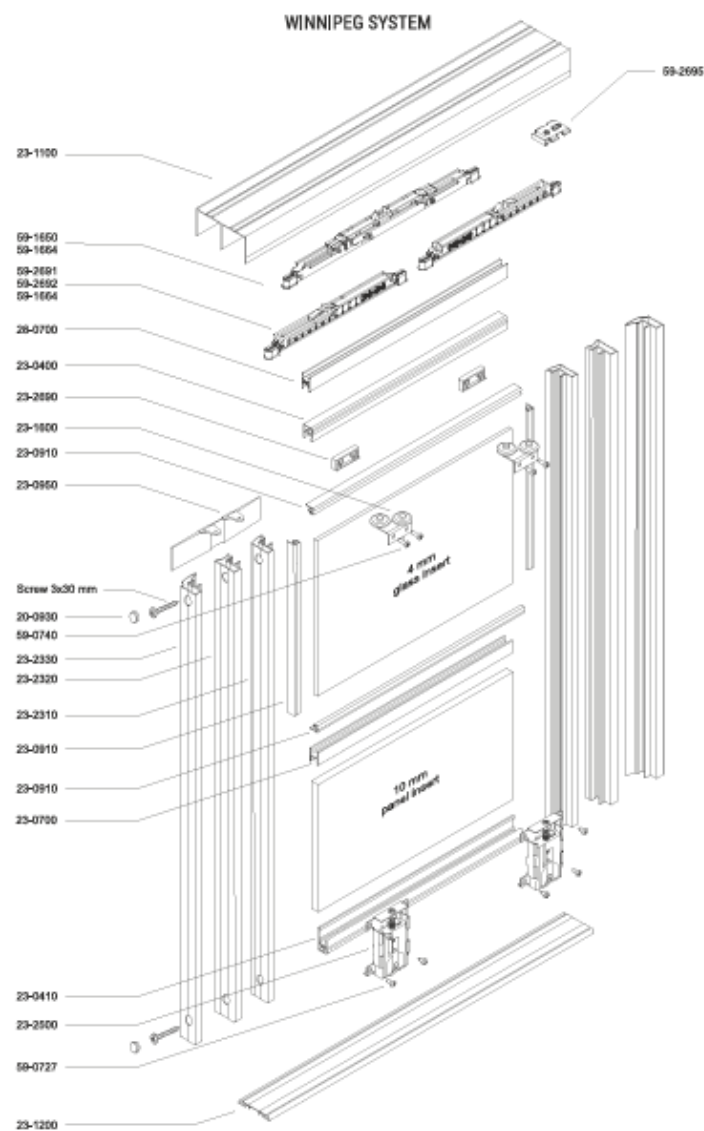

WINNIPEG

23-1100-#
Tor górny 36 mm 5500 mm
Top track 36 mm - 5500 mm
Raíl supérieure 36 mm 5500 mm

- AN, AS



2 pcs./pack

23-1200-#
Tor dolny 36 mm 5500 mm
Bottom track 36 mm - 5500 mm
Raíl inférieur 36 mm 5500 mm

- AN, AS



2 pcs./pack

23-2310-#
Ramiek pionowy WINNIPEG 1, 2700 mm
WINNIPEG 1 stile - 2700 mm
Montant WINNIPEG 1, 2700 mm

- AN, AS



69-0331

20 pcs./pack

23-2320-#
Ramiek pionowy WINNIPEG 2, 2700 mm
WINNIPEG 2 stile - 2700 mm
Montant WINNIPEG 2, 2700 mm

- AN, AS



69-0331

20 pcs./pack

23-2330-#
Ramiek pionowy WINNIPEG 3, 2700 mm
WINNIPEG 3 stile - 2700 mm
Montant WINNIPEG 3, 2700 mm

- AN, AS



69-0331

20 pcs./pack

23-0400-#
Ramiek poziomy 1800 mm
Raíl - 1800 mm
Traverse 1800 mm

- AN, AS



69-0331

20 pcs./pack

23-0410-#
Ramiek poziomy dolny 1800 mm
Bottom raíl - 1800 mm
Traverse inférieur 1800 mm

- AN, AS



69-0331

20 pcs./pack

23-0700-#
Listwa łącząca 1800 mm
Joiner raíl - 1800 mm
Traverse en 'H' 1800 mm

- AN, AS



max. 3 szt.

20 pcs./pack

#-AN, AS, BI

Technical drawing of the 23-1900 and 23-2600 cable assemblies. The drawing shows two views of the assemblies. The left view shows the 23-1900 assembly with dimensions 12, 20, and 10. The right view shows the 23-2600 assembly with dimensions 10 and 4. A separate view of the 23-0910 cable is shown at the top right.



Technical drawings of the 5000 Series 1/2" valve. The top left shows a top view with dimensions 50 and 40. The top middle shows a side view with dimensions 14 and 1.5. The top right shows a front view of the valve body. The bottom left shows a side view of the valve handle. The bottom right shows a detail view of the valve handle with the part number 50-0727 and a dimension of 12 mm.

Technical drawing and 3D model of a grey Technic beam. The drawing shows a top view with dimensions 35 (length) and 14 (width), and a side view with dimensions 8 (height) and 7.5 (thickness). The beam has two holes spaced 14 units apart. The 3D model shows the beam's profile.

20 pcs./pack



DRZWI PRZESUWNE SERIA 23 SLIDING DOORS THE 23 SERIES



59-1650

Domykacz środkowy
Middle doors air spring
Amortisseur central

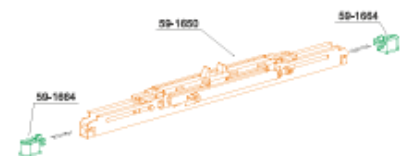

5 pcs./pack

59-1664

Zaczep domykacza środkowego / Uno AL25 / Winnipeg
Middle doors air spring / Uno spring mount AL25 / Winnipeg
Attache d'amortisseur central / Uno AL25 / Winnipeg

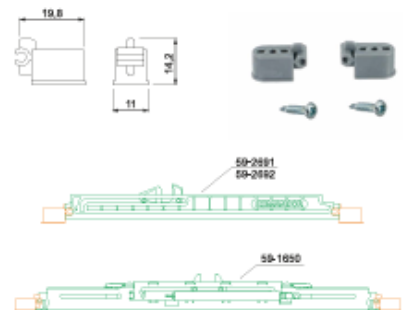

20 sets./pack

59-2695

Chwytek domykacza Uno
Uno air spring catch
Doigt d'entraînement pour amortisseur Uno

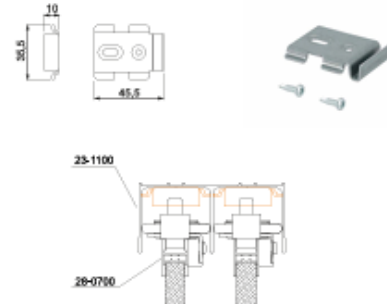

59-2691 / 59-2692

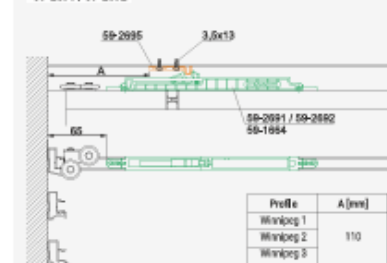

59-1650

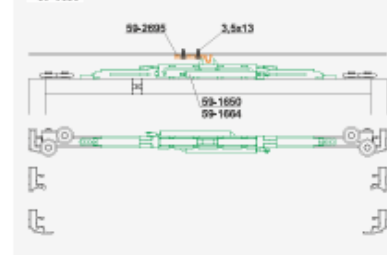

30 pcs./pack





KOMANDOR CANADA CLOSETS & DOORS INC.
863 Rangeview Rd., Mississauga, ON L5E 1H1
tel: 905.766.0880 www.komandor.ca